

Routing Spec Sheet

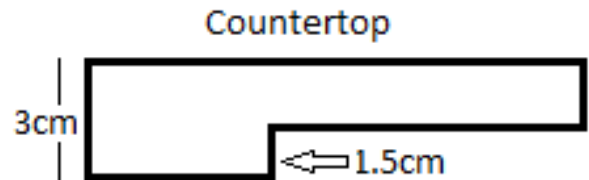
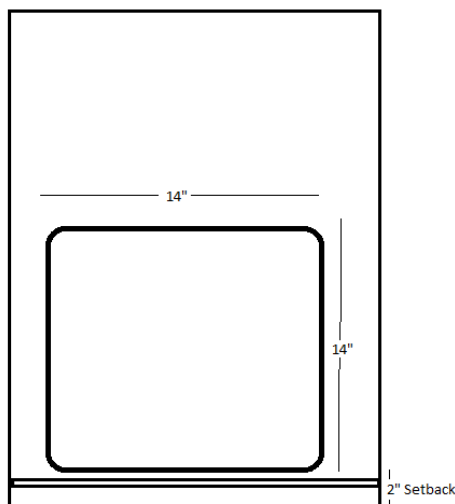
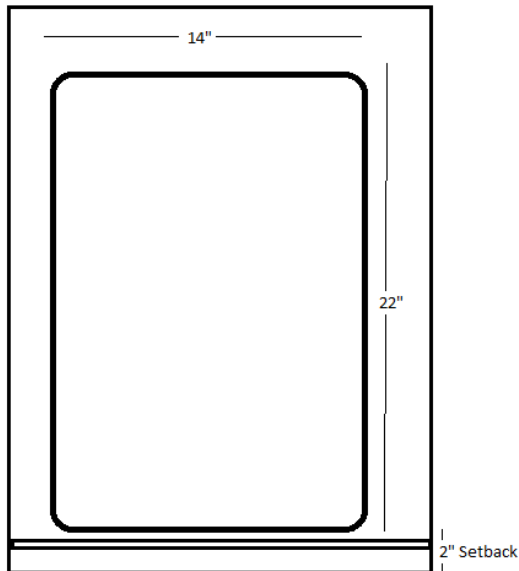
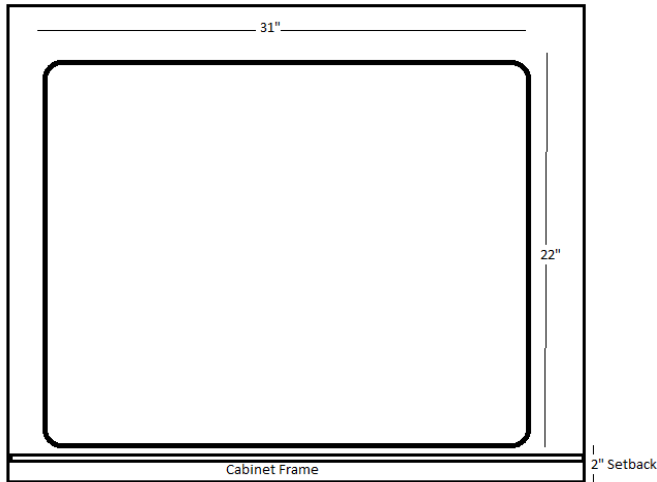

Milling Countertop Specs

- Invisacook recommends for best results of the Invisacook feature is to have your material thickness be milled down at 1.5cm or 5/8" Inch
- Invisacook Highly recommends the use of a C&C Machine to accomplish this, with the Hiring of a well certified fabricator.
- A DFX file is available on the site for fabricators to us on their C&C Machine
- Option 2 is a Stone Plunge Router, which is to be Done with water for safe practices.
- Best practices recommend that a Diamond Finger Bit is used in this process with Granite, Quartz and Marble

Invisacook LLC

305 Summerset Dr
Switzerland, FL 32259

www.invisacook.com