

ROUTING SPEC SHEET

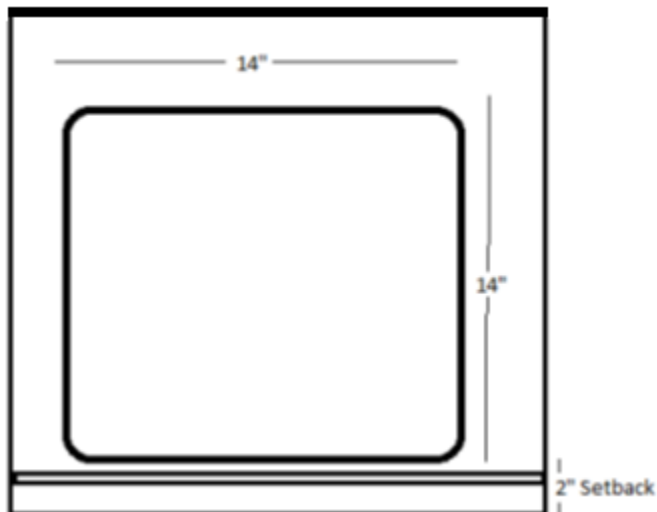

INVISACOOK

What You Don't See Won't Burn You

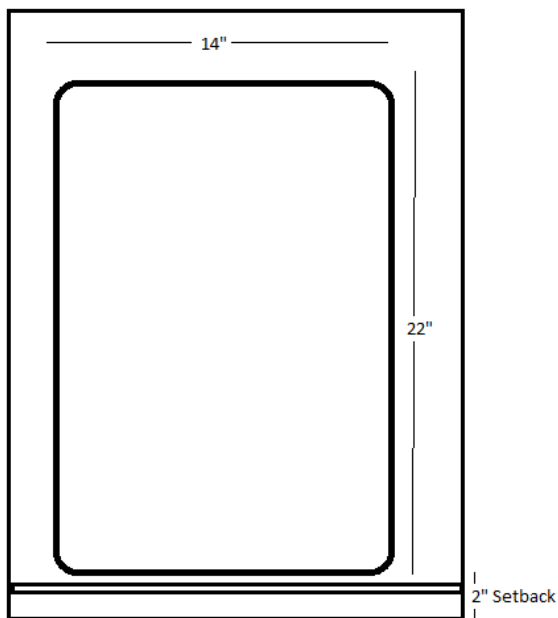
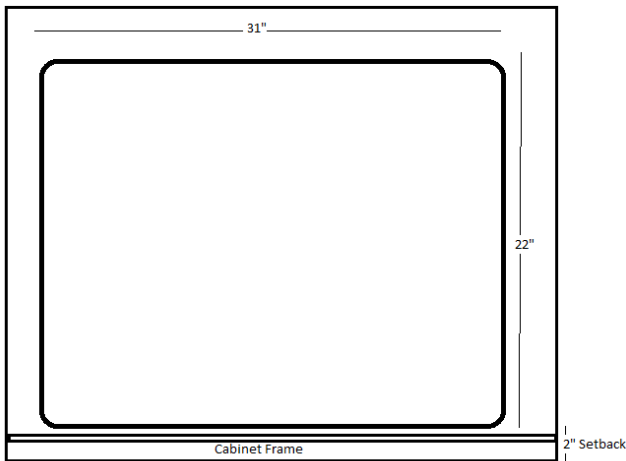
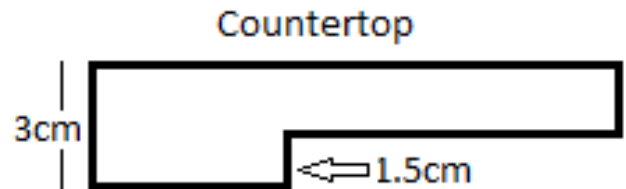

Milling Countertop Specs

- Invisacook recommends for best results of Invisacook feature is to have your material thickness be milled down at 1.5cm or 5/8" Inch
- Invisacook Highly recommends the use of a C&C Machine to accomplish this, with the Hiring of a well certified fabricator.
- A DFX file is available on the site for fabricators to us on their C&C Machine
- Option 2 is a Stone Plunge Router, which is to be Done with water for safe practices.
- Best practices recommend that a Diamond Finger Bit is used in this process with Granite, Quartz and Marble

InvisaCook LLC

4601 E Moody Blvd – Unit H2

Bunnell, FL 32110

www.invisacook.com

Undermount Installation

Step 1: Locate the Invisacook Centerline with the cabinet, and trace out the outer rim of the Cooktop

Step 2: Locate where your Cuts for your Mounting Clips will be placed, Cut them as needed.

Step 3: Swab on the Magnetic Juice to each Burner, and flip over the unit to attach to countertop using your wing nut clips to tighten to top. Note to tighten so its firm to the top, not over tightened.

<<< See how its attached

Last Step: Locate where the controls are to be mounted as show here being mounted to a Tilt Out Drawer

